



Before starting installation, review this document to ensure that all parts and hardware are included in the package.

**In the event that parts are missing, please contact MASTERACK at 1-800-222-8785 to re-order missing parts.**

# Locking Ladder Rack Assembly Instructions



**MASTERACK.COM**

MASTERACK Headquarters  
2400 Mellon Court  
Decatur, GA 30035  
800-222-8785

### ■ Locking Ladder



### ■ Recommended Tools

- Wrench or Socket (1/2")

### ■ Parts List

#### Components

Item	Qty	Description
1	1	Outer Tube
2	1	Rod Handle
3	1	Rung Hook
4	1	Front Stop (8" stop on model 021226)
5	1	Axle Housing
6	1	Handle Lock
7	1	Inboard Rail
8	1	Axle Tube

#### Hardware

Item	Qty	Description
9	4	Carriage Bolt - 3/8" x 1"
10	1	Carriage Bolt - 3/8" x 2 1/4"
11	1	Hex Socket Screw Set - Nylon
12	8	Screw Cap - 5/16" x 2"
13	8	Nut - 5/16"
14	5	Nut - 3/8"
15	1	Spacer - 3/8"
16	2	Pin - 3/16" x 2"
17	16	Washer - 5/16" Neoprene
18	8	Washer - 5/16" Flat
19	5	Washer - 3/8" Flat
20	2	Tube Insert
21	2	Bearing
	1	
	1	



Before starting installation, review this document to ensure that all parts and hardware are included in the package.

**In the event that parts are missing, please contact MASTERACK at 1-800-222-8785 to re-order missing parts.**

## ■ Assembly

### Step 1

Insert the (1) FRONT STOP (Item 4) through the slots in the front CROSSBOW and align so that the vertical section of the FRONT STOP touches the CROSSBOW. Secure together with (1) 3/8" x 1" CARRIAGE BOLT (Item 9), (1) 3/8" FLAT WASHER (Item 19), and (1) 3/8" NUT (Item 14). Bolt head should be facing upward. See Figure 1.

**Note:** Front stop may require further adjustment for proper operation. See operating instructions.

### Step 2

Locate the INBOARD RAIL (Item 7) and (1) BEARING (Item 21). Insert BEARING into pre-punched hole in INBOARD RAIL. See detail B.

Insert each end of the INBOARD RAIL into the front and rear CROSSBOWS and attach using (2) 3/8" x 1" CARRIAGE BOLTS (Item 9), (2) 3/8" FLAT WASHERS (Item 19), and (2) 3/8" NUTS (Item 14). Bolt head should be facing upward. See Figure 2 and Detail A.

**Note:** Flat side of INBOARD RAIL (with holes) always faces the inside of the assembly. Flanges should be facing outward. See Figure 2.

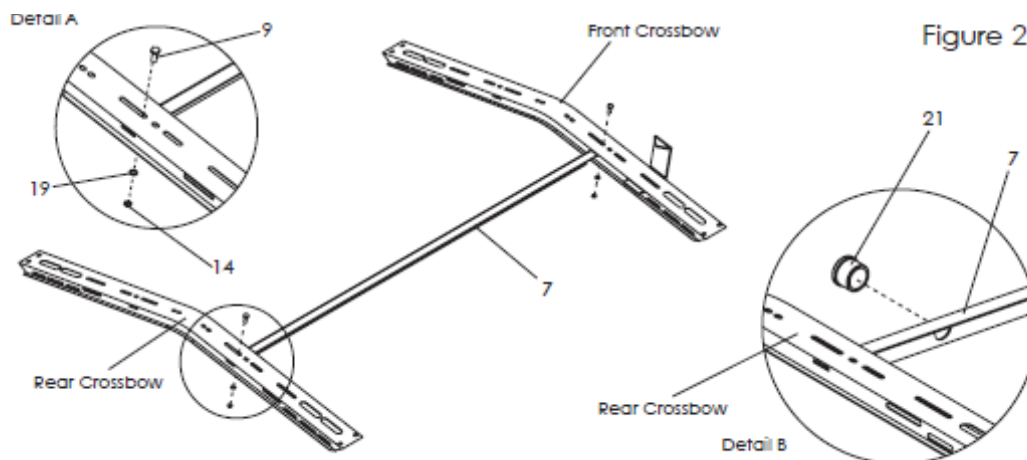
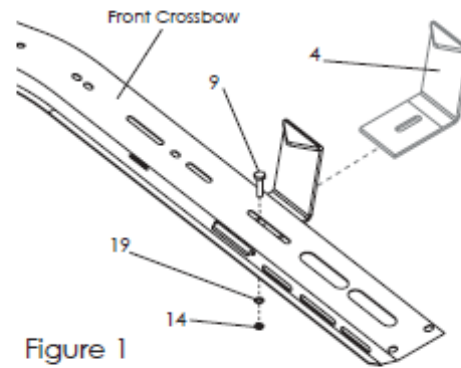

### Step 3

Place (2) TUBE INSERTS (Item 20) into the ends of the OUTER TUBE (Item 1). See Figure 3A. Attach the OUTER TUBE (Item 1) to the front and rear CROSSBOWS using (4) 5/16" X 2" SCREW CAPS (Item 12), (8) 5/16" NEOPRENE WASHERS (Item 17) directly under the screw heads and also between OUTER TUBES and CROSSBOWS 5/16" NUTS (Item 13). The curved end on OUTER TUBE should be facing upward. See Figure 3A.

### Step 4

Insert the other BEARING (Item 21) into the AXLE HOUSING (Item 5). See Figure 3B. Next, attach the AXLE HOUSING to the OUTER TUBE using (2) 5/16" X 2" SCREW CAPS (Item 12), (4) 5/16" NEOPRENE WASHERS (Item 17) directly under the screw heads also between AXLE HOUSING and OUTER TUBE, (2) 5/16" FLAT WASHERS (Item 18), and (2) 5/16" NUTS (Item 13). Tighten securely. All bolt heads face upward. See Figure 4.

### Step 5

Orient the HANDLE LOCK (Item 6) as shown in Figure 5, and attach it to the OUTER TUBE using (2) 5/16" X 2" SCREW CAPS (Item 12), (4) 5/16" NEOPRENE WASHERS (Item 17) directly under the screw heads also between OUTER TUBE and HANDLE LOCK, (2) 5/16" FLAT WASHERS (Item 18), and (2) 5/16" NUTS (Item 13).

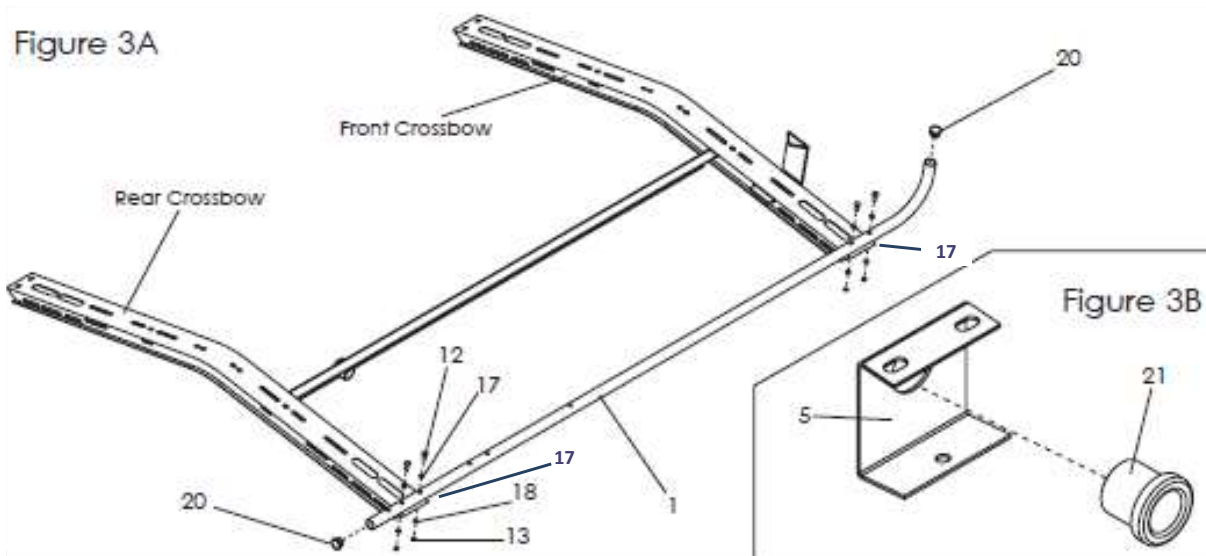

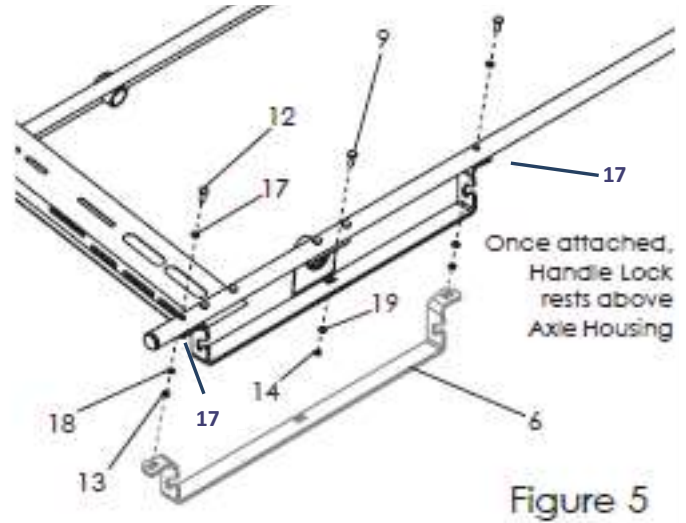
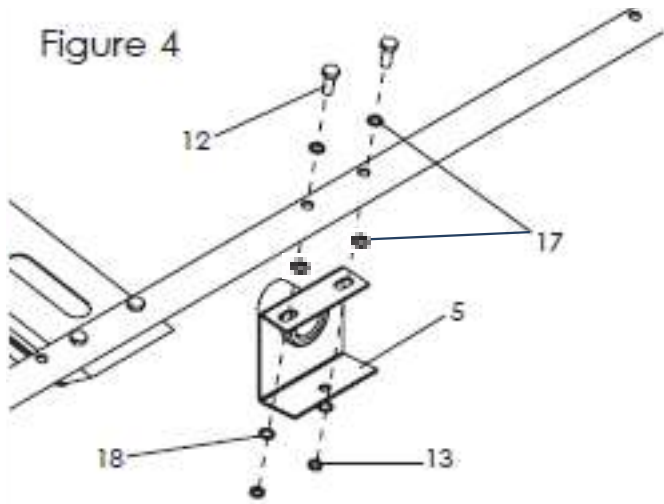

### Step 6

Slip the AXLE TUBE (Item 8) through the BEARINGS in the AXLE HOUSING and the INBOARD RAIL. Secure with (2) 3/16" x 2" PINS (Item 16). See Figure 6A and Detail C. Place the RUNG HOOK (Item 3) on the AXLE TUBE and attach with (1) 3/8" x 2-1/4" CARRIAGE BOLT (Item 10), (1) 3/8" FLAT WASHER (Item 19), and (1) 3/8" NUT (Item 14). Tighten. See Figure 6B. See Figure 5. heads face upward. See Figure 4.

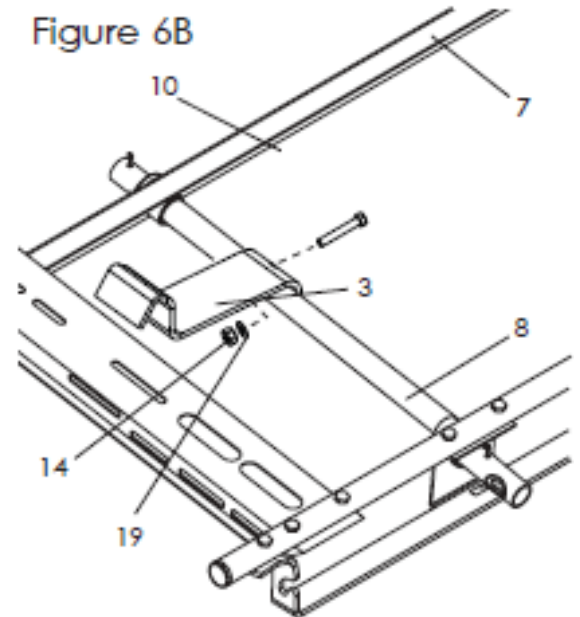
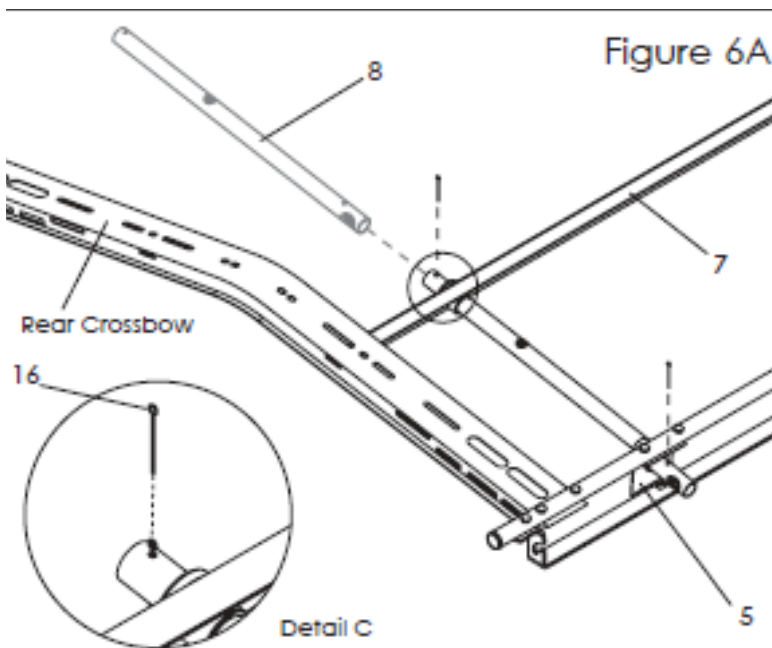

### Step 7

Rotate the RUNG HOOK until it rests on the rear CROSSBOW as shown in Figure 7A. Insert (1) 3/8" SPACER (Item 15) into AXLE TUBE and orient so that the hole in the SPACER is facing outward. Once the RUNG HOOK is positioned properly, insert the ROD HANDLE (Item 2) through the AXLE TUBE and the SPACER. Tighten the HEX SOCKET SCREW SET (Item 11) in the SPACER so that it seats in the pre-drilled area in the ROD HANDLE. The ROD HANDLE should now lock into the forward lock position on the HANDLE LOCK. See Figure 7B.

Figure 7A

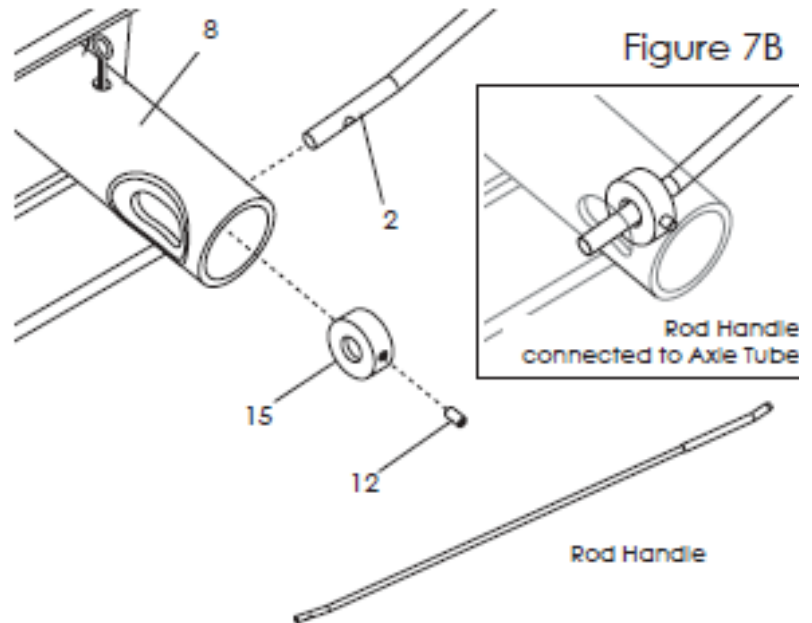
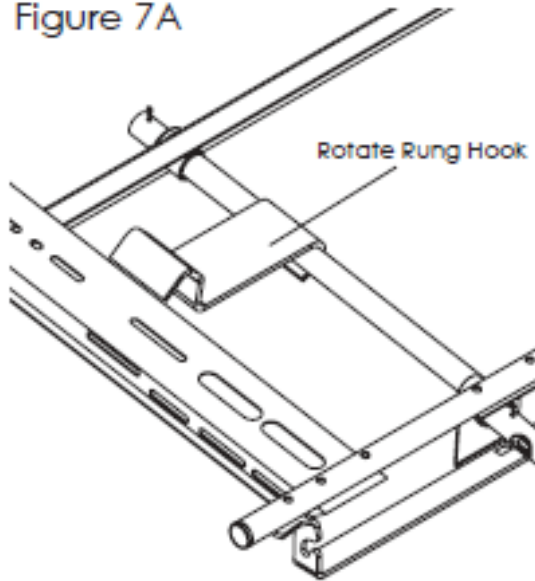

## ■ Operating Instructions

In the UNLOCKED position, the ROD HANDLE should be securely seated in the forward position of the HANDLE LOCK.

To LOAD the ladder, lay it across and to the inside of the OUTER TUBE. Pivot the rear of the ladder up onto the ladder rack and push it firmly against the FRONT STOP

LOCK the ladder in place on the ladder rack by rotating the ROD HANDLE to the rearward position of the HANDLE LOCK.

UNLOAD the ladder by lifting the rear of the ladder and pivoting it downward.

The FRONT STOP may be adjusted forward or backward to establish proper tension on the ladder.

During use, periodically check the ladder for proper tension and check the fasteners at all points where the ladder rack is attached to the vehicle. Tighten as necessary.

■ Loading

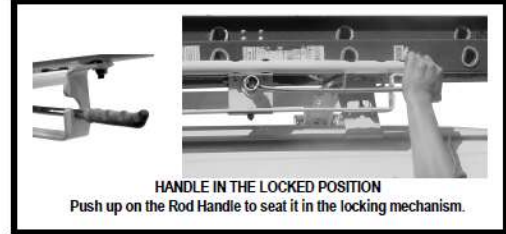
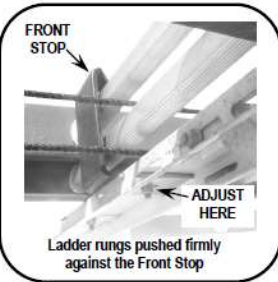
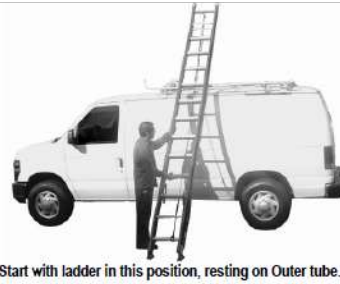
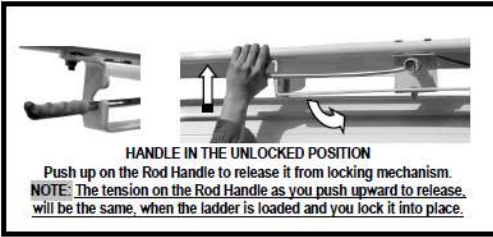

Lock the ladder in place by rotating the Rod Handle to the rearward Locked position in the locking mechanism.



**IT WILL BE NECESSARY TO ADJUST THE FRONT STOP TO ACCOMMODATE YOUR LADDER. ADJUST IN FOR MORE TENSION, ADJUST OUT TO LESSEN TENSION.**



■ Unloading

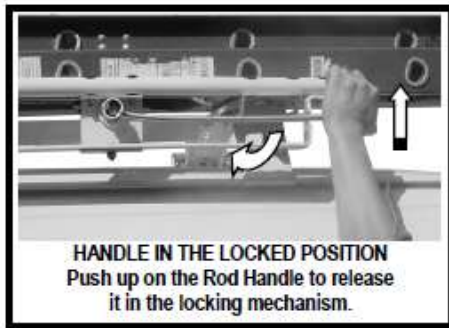

Rotate the rear of the ladder to the ground, resting front of ladder on Outer Tube



After removing ladder, return Rod Handle to the Unlocked Position in the locking mechanism.

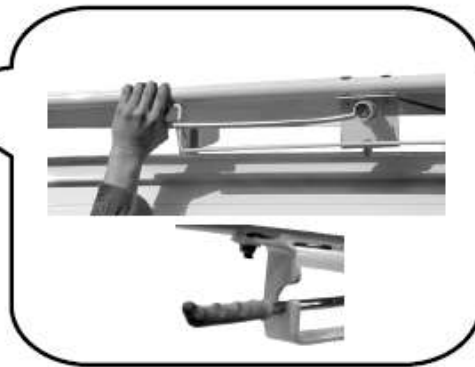

## MASTERACK® 3 Year / 36,000 Mile Limited Warranty

MASTERACK® commercial van and pickup equipment is warranted to be from defects in material and workmanship, under normal use and service for a period of one (1) year from date of purchase. Factory installations, and products installed in new vehicles by an authorized MASTERACK® installer are warranted for (3) years or 36,000 miles (60,000KM), whichever comes first. **This warranty covers only repairs, or at MASTERACKS' discretion, replacement to correct any defects related to materials and workmanship.**

### This warranty does not apply to:

- Additions, alterations, or installations made by persons including dealers, other than MASTERACK® and its authorized distributors, made in accordance with MASTERACK® specifications and / or instructions, nor to defects arising out of attribute to such additions, alterations or installations.
- Defects attributable to abuse or misuse of the product, misapplication, negligent accident, modification or tampering.
- Damage resulting from failure to promptly notify and comply with the instructions of the dealer or manufacturer about defects when noted.
- Any incidental or consequential damages connected with a defect, either while under warranty or afterward, including the cost of a rental truck and / or loss or revenue.

**THE WARRANTY IS THE ONLY WARRANTY APPLICABLE TO A MASTERACK PRODUCT PURCHASE. ALL OTHER WARRANTIES, EXPRESSED OR IMPLIED, INCLUDING BUT NOT LIMITED TO, THE IMPLIED WARRANTIES OR MERCHANTABILITY AND FITNESS FOR A PARTICULAR PURPOSE ARE DISCLAIMED. MASTERACK® AND ITS SUBSIDIARIES, SHALL NOT BE LIABLE FOR ANY INCIDENTAL OR CONSEQUENTIAL DAMAGES ARISING OUT OF ANY BREACH OF THIS WARRANTY, NOR SHALL THE DAMAGES EXCEED THE RETURN AMOUNT OF THE PURCHASE PRICE PAID BY THE ORIGINAL PURCHASER.**

Warranty claims must be submitted to either your sales representative or a customer service representative at **816-455-0218**. The vehicle must be delivered to the original MASTERACK® authorized dealer for inspection and any warranty service. Any warranty service to be performed by a source other than MASTERACK® location or an approved MASTERACK® distributor must be authorized in advance of the repairs by the MASTERACK® Warranty Administrator and a purchase order issued by MASTERACK® in advance or repairs for the authorized repairs.